

# Operation Manual

- Oval pipe-mounted tank
- Trio pipe-mounted tank
- Quadro pipe-mounted tank
- Suspended oval tank
- Zebra pipe-mounted tank
- Zebra pipe-mounted tank with an offset axis
- Zebra pipe-mounted tank for Aurora TRIO heater
- Heat-exchanger tank

Please, read this Manual carefully prior to commencing the tank installation and operation!

## 1. APPLICATION

Pipe-mounted tank and heat exchanger are designed to provide hot water a room equipped with a heater and a chimney.

## 2. PACKAGE CONTENTS

Tank – 1 piece (Heat exchanger – 1 piece)

Lid – 1 piece (pipe-mounted tank, suspended tank) Operation Manual – 1 piece.

## 3. DESIGN AND OPERATING PRINCIPLE

Oval pipe-mounted tank (Fig. 1) is an oval-shaped metal body that is installed on the chimney and is designed to produce hot water via heat pick-up from the chimney. Trio pipe-mounted tank is a triangular metal body. The design provides for a possibility of attaching a water tap.

Suspended oval tank (Fig. 2) is an oval-shaped metal body for vertical installation; it is attached to the wall. It is used for temporary storage of cold water. It can be used to provide hot water, when combined with the heat exchanger. The design provides for a possibility of attaching a water tap.

Zebra pipe-mounted tank (Fig. 3) is cylindrical metal body that is installed on the chimney and is - to produce hot water via heat pick-up from the chimney. The design provides for a possibility of attaching a water tap.

Zebra pipe-mounted tank with an offset axis has a special design that allows using the tank in case of physical proximity of the chimney axis to the edge of the heater.

## 4. TECHNICAL DATA

Name	Volume, l	Material (steel grade)	Pipe diameter, mm	Pipe length, mm	Pipe thickness, mm	Body dimensions, mm					
						Diameter	Height	Width	Length		
Oval pipe- mounted tank	50		115/120	770	0.8	-	550	280	420		
	70			920	0.8	-	700				
Trio pipe- mounted tank	50		HRS/AHRS*	115/120	720	0.8	390	480	-	-	
	70				910	0.8	390	670	-	-	
Quadro pipe- mounted tank	60			720	0.8	-	390	-	-	-	
	80			850	0.8	-	520	415	-	415	
	100			920	0.8	-	650	-	-	-	
	60			-	-	-	425	-	-	-	
Suspended oval tank	80		HRS/AHRS*	115/120/150	-	-	-	566	280	570	
	100				-	-	708	-	-	-	
	30				500	0.8	400	250	-	-	
Zebra pipe- mounted tank	50			HRS/AHRS*	115/120/150	670	0.8	400	400	-	-
	70	830				0.8	400	560	-	-	
	50	670				0.8	400	400	-	-	
Zebra pipe- mounted tank with an offset axis	70	HRS/AHRS*			115/120	830	0.8	400	560	-	-
	8					600	0.8	200/200/230	350	-	-
Heat-exchanger	60				HRS*	115	680	0.8	450	400	-
Tank for Aurora TRIO heater	60			680			0.8	450	400	-	-

\*HRS for heat-resistant steel, AHRS for acid-and-heat-resistant steel (only for PREMIUM series)

- Minimum water pressure upstream of the heat exchanger is 0.06 MPa (0.6 kgf/cm<sup>2</sup>);
- Maximum heating temperature is 95°C

Heat exchanger is a leak tight pipe-mounted tank with a volume of 8 l. It is mounted onto the chimney in order to accumulate the heat in the water tank via transferring heat energy from the chimney to a closed water loop. It is recommended to use with a suspended oval tank.

## **5. PROTECTIVE MEASURES**

**IMPORTANT! THE FOLLOWING IS PROHIBITED DURING INSTALLATION AND OPERATION OF THE TANKS:**

- Installing the tank in places that do not comply with fire safety measures;
- Making changes in the design, use the Product for other purposes;
- Operating the tanks without filling them up with water;
- Using water with a high content of salts, iron, lime and other impurities that do not meet the standards (pH > 7);
- Leaving water in the tank at any time of the year.

## **6. INSTALLATION AND PRESTARTING PROCEDURES**

Installation of the tank shall be carried out by a licensed company and competent specialists. Prior to installation, remove the protective film, check the tank for tightness via filling it up with water, then wash the tank. For a reliable connection of the tank with the chimney apply high-temperature sealants on the junctions. Follow local regulations, including those referring to the national standards, during installation and operation.

## **7. PROCEDURE FOR OPERATION AND MAINTENANCE**

Fill the system up with water, ignite the firebox of the bath house heater. As the heater is being stoked and the room is being heated, you will be provided with hot water. If additional volume of hot water is necessary in the process of bathing and other activities, add cold water to the system and stoke the heater for the required period of time. It is necessary to periodically clean the tanks from accumulated blockages and wash them with running water, at least once every 6 months. In case of increase of the water heating time, as well as during long-term operation, check the connecting pipes for blockages and scaling. Remove blockages and scaling, if any. Rust, salt deposits and scaling can form during operation under the influence of various external factors.

## **8. WARRANTY**

OOO Sferra guarantees proper operation of the tank subject to the requirements for installation and operation described in this Manual. The warranty period is 12 months from the date of sale.

**IMPORTANT! TANKS AS FOLLOWS SHALL NOT BE ACCEPTED FOR GUARANTEED REPAIR SERVICES:**

- Without Operation Manual stamped by the retailer with an indication of the sale date;
- Damaged due to the Consumer's fault;
- After non-guaranteed repair services;
- Discrepancy between the serial number specified in the Operation Manual with the number engraved on the top lid of the tank.

Fig. 2

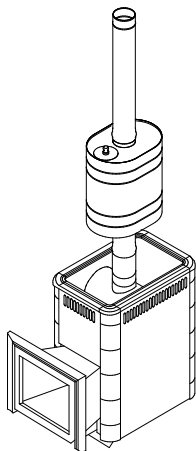
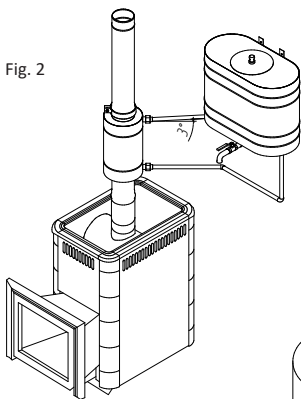

Fig. 1

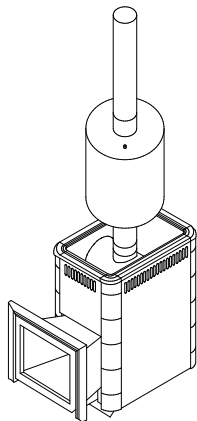

Fig. 3

Production date: \_\_\_\_\_ Serial number: \_\_\_\_\_

Date of sale: \_\_\_\_\_

(Date, Seller's signature, store stamp)

I have read and understood this Manual: \_\_\_\_\_

(Buyer's signature)